

## Clutch

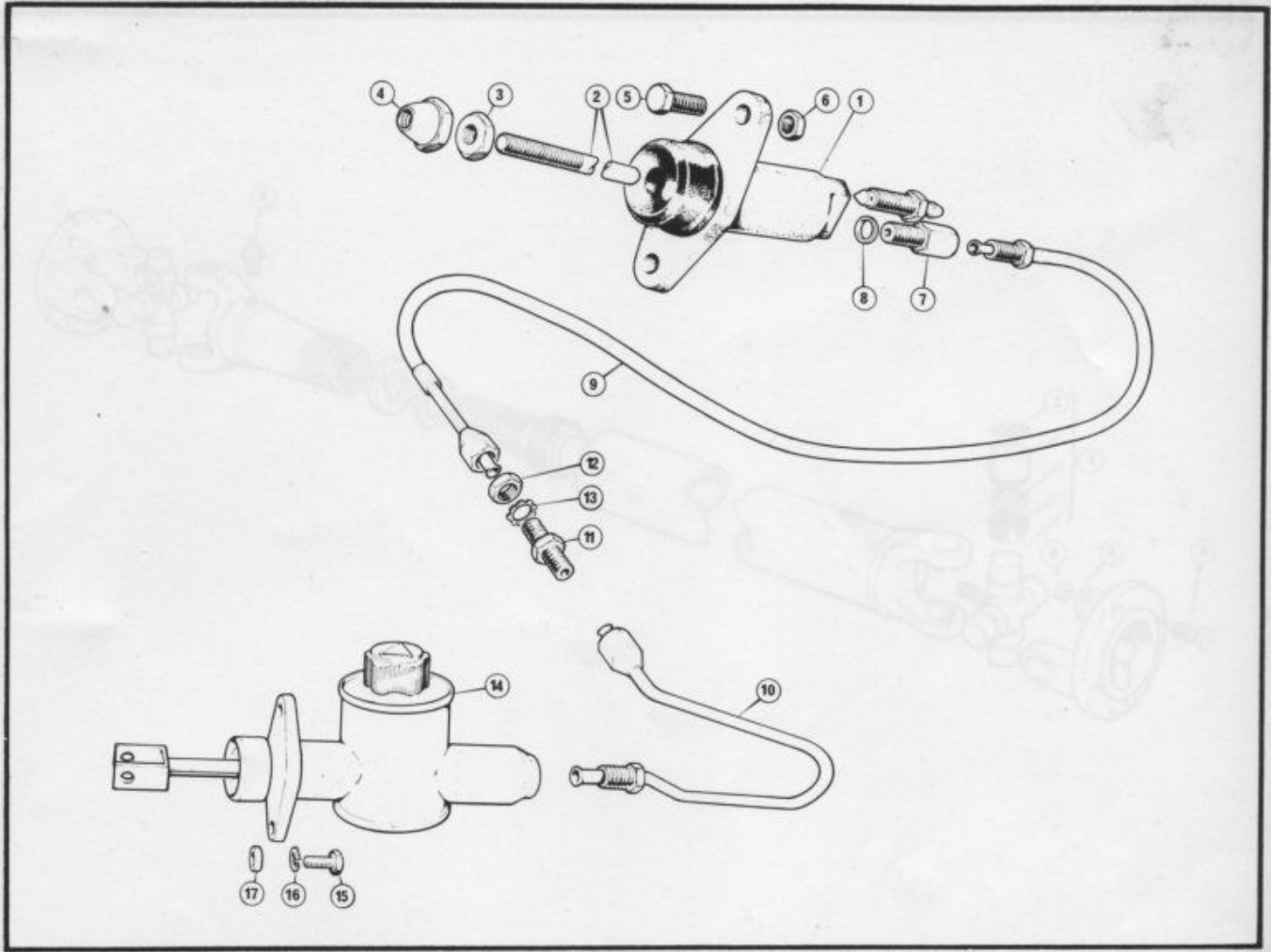

PART No.	DESCRIPTION	ITEM	QTY. REQ.	REMARKS
<b>CLUTCH - Clutch Hydraulics</b>				
20300	Slave cylinder .....	1	1	Replaced by 21083
21083	Slave cylinder .....	1	1	Replaces 20300
18156	Push rod, slave cylinder operating .....	2	1	.....
50704B	Locknut, slave cylinder operating .....	3	1	.....
4920	Domed nut, slave cylinder operating .....	4	1	.....
50040B	Bolt, slave cylinder .....	5	2	.....
51002B	Nut, slave cylinder .....	6	2	.....
20386	Adaptor, clutch hose .....	7	1	.....
20387	Gasket, clutch hose .....	8	1	.....
20305	Clutch hose .....		1	These items are for use with slave cylinder 20300 only
20312	Bundy, clutch master cylinder to connector .....		1	
20304	Connector, bundy to hose .....		1	
20302	Locknut, connector .....		1	
20303	Lockwasher, connector .....		1	These items are for use with slave cylinder 21083 only
21094	Clutch hose .....	9	1	
21095	Bundy, clutch master cylinder to connector .....	10	1	
21096	Connector, bundy to hose .....	11	1	
21097	Locknut, connector .....	12	1	.....
21098	Lockwasher, connector .....	13	1	.....
20389	Clutch master cylinder .....	14	1	.....
51483B	Set screw, master cylinder mounting .....	15	4	.....
51202B	Lockwasher, master cylinder mounting .....	16	4	.....
20095	Spacer, clutch master cylinder .....	17	2	.....

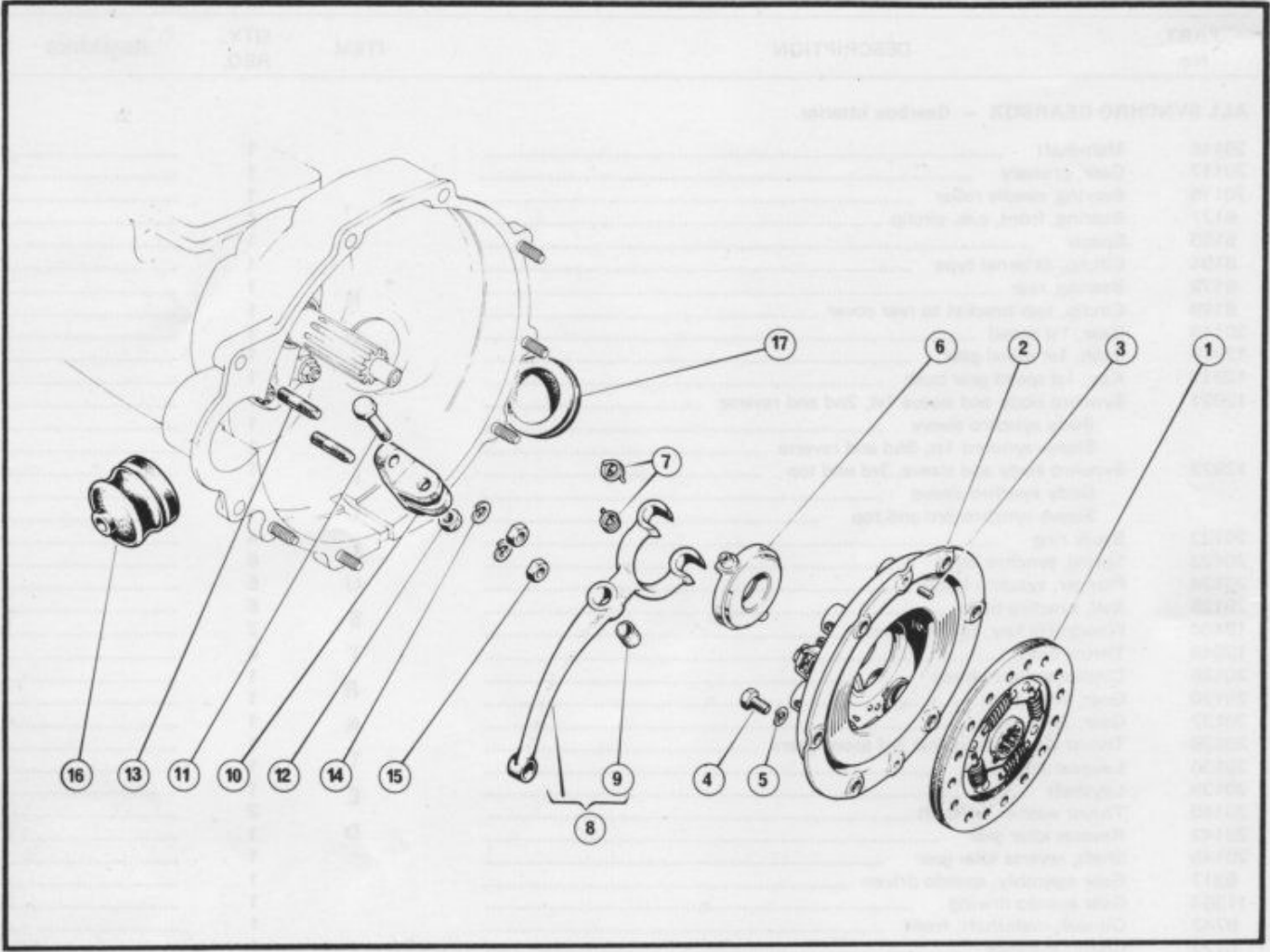

PART No.	DESCRIPTION	ITEM	QTY. REQ.	REMARKS
<b>CLUTCH</b>				
6360	Driven plate, spring centre .....	1	1	.....
2562	Clutch cover assembly .....	2	1	.....
6152	Dowel, clutch location .....	3	2	.....
51481	Set screw, clutch fixing .....	4	6	.....
51202	Lockwasher, clutch fixing .....	5	6	.....
1999	Thrust pad, clutch operating .....	6	1	.....
2586	Retaining clip, clutch operating .....	7	2	.....
20358	Fork, clutch operating .....	8	1	.....
6323	Bush, fork .....	9	1	.....
6325	Bracket, fork mounting .....	10	1	.....
50045	Bolt, fork pivot .....	11	1	.....
51002B	Nut, fork pivot .....	12	1	.....
6331	Stud, bracket to gearbox case .....	13	1	.....
51201	Lockwasher, bracket to gearbox case .....	14	2	.....
50681	Nut, bracket to case .....	15	2	.....
6324	Gaiter, clutch operating fork .....	16	1	.....
6326	Grommet, gearbox case .....	17	1	.....